

SHOCK SPECIFICATIONS

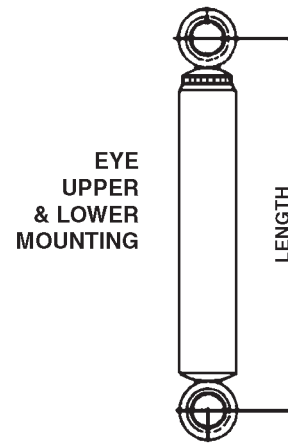

CROSS-PIN MOUNTING CODES

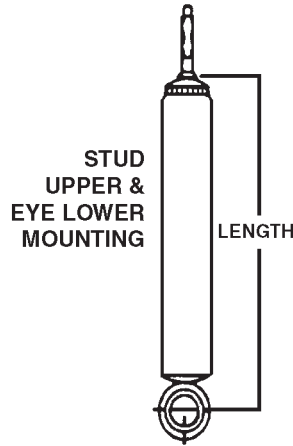
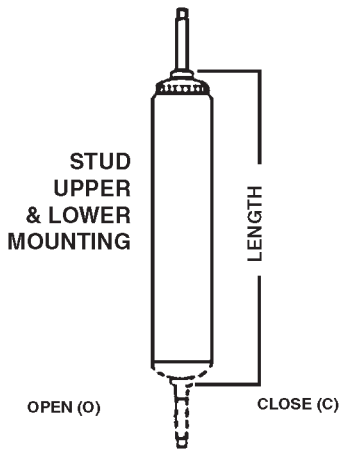
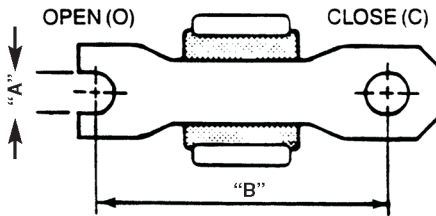

CODE	END	A	B
XP1	O	5/16	2 - 3/16
XP4	C	5/16	2 - 7/16
XP5	C	5/16	2 - 1/2
XP7	C	5/16	2 - 7/8
XP8	O	5/16	3
XP12	O	3/8	3 - 3/16

STEM MOUNTING CODES

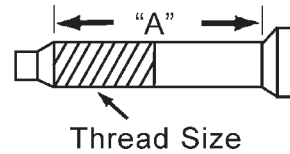

CODE	A	Threads
S12	1 - 3/16	M10
S15	2 - 5/8	10MM
S33	2	3/8 - 24
S34	2 - 1/4	3/8 - 24
S42	2 - 3/8	3/8 - 16
S51	2 - 5/8	1/2 - 13
S52	2 - 5/8	1/2 - 20
S62	2 - 1/2	5/8 - 18

BUSHING MOUNTING CODES

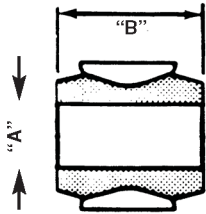

CODE	A	B
L1	5/8	1 - 5/16
L2	11/16	1 - 9/16
L3	3/4	1 - 9/16

BUSHING & SLEEVE MOUNTING CODES

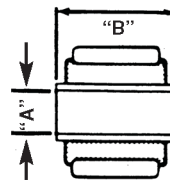

CODE	A	B	CODE	A	B
LS12	7/16	1 - 1/4	LS43	14MM	1 - 9/16
LS21	12MM	1	LS44	14MM	1 - 7/8
LS23	12MM	1 - 1/4	LS47	9/16	1 - 5/8
LS24	12MM	1 - 3/8	LS5	10MM	1 - 7/16
LS25	12MM	1 - 7/16	LS51	5/8 / 16MM	1 - 9/16
LS26	12MM	1 - 1/2	LS52	5/8 / 16MM	1 - 11/16
LS28	12MM	1 - 5/8	LS53	5/8 / 16MM	2
LS29	12MM	1 - 3/4	LS70	3/4	2 - 1/4
LS30	12MM	1 - 7/8	LS74	12MM	1 - 11/16
LS35	1/2	1 - 1/4	LS77	1/2	2 - 7/16
LS36	1/2	1 - 5/16	LS78	9/16	1 - 1/2
LS37	1/2	1 - 3/8	LS82	5/8 / 16MM	1 - 1/2
LS38	1/2	1 - 1/2	LS91	14MM	1 - 3/4
LS39	1/2	1 - 5/8	LS92	14MM	1 - 11/16
LS40	1/2	1 - 11/16	LS93	18MM	3 - 1/4
LS41	1/2	2 - 1/4	LS94	5/8 / 16MM	2 - 3/4
LS42	14MM	1 - 5/16	LS95	20MM	2 - 3/8

Many shocks come with a parts package containing mounting hardware to reduce 5/8" rubber bushing eye to 9/16" or 1/2" allowing for multiple vehicle applications. All mounting code dimensions are approximate and subject to change without notice. RS5000 shocks are 1 3/8" Bore and RS5600 shocks are 1 3/16" Bore.

Rancho only engineers its shock absorbers for the applications listed in this catalog. Misapplication of Rancho shock absorbers will result in reduced handling and braking ability.

NOTE: Internal extension bumper may reduce perceived extended length by 1/2".
 Extended and collapsed length dimensions shown for RS5000 shocks, others may vary slightly.

PART NO.	MOUNTING CODES		LENGTHS			DUST SHIELD	PARTS PACK
	UPPER	LOWER	COMP.	EXT.	TRAV.		
RANCHO RS5000 Shock Absorber							
RS5001	LS41	LS37	13.250	21.125†	7.875	NONE	NONE
RS5005	LS39	L2	17.250	28.875†	11.625	NONE	NONE
RS5006	L1	L1	11.750	18.000†	6.250	NONE	P915, P1057
RS5007	L1	LS26	14.875	24.250†	9.375	NONE	NONE
RS5008	L1	L1	13.750	22.500†	8.750	NONE	P915, P1057
RS5009	S42	LS38	15.625	26.250†	10.625	NONE	P1134
RS5010	L1	L1	15.875	26.250†	10.375	NONE	P915, P920, P1057
RS5012	L1	L1	19.000	32.500†	13.500	NONE	P915, P934
RS5014	S42	S42	14.750	24.875†	10.125	NONE	Two P1134
RS5017	S42	LS38	15.125	25.250†	10.125	NONE	P1135
RS5029	S42	LS26	9.625	14.250†	4.625	NONE	P1135
RS5034	L1	L1	20.000	34.000†	14.000	NONE	P915, P1013
RS5036	L1	L1	21.125	36.000†	14.875	NONE	P915, P1013
RS5039	S42	L1	9.625	14.250†	4.625	NONE	P1013, P1134
RS5040	S42	LS12	13.875	22.250†	8.375	NONE	P1134
RS5041	S42	LS12	13.250	21.375†	8.125	NONE	P1134
RS5042	S51	LS47	13.750	20.750†	7.000	NONE	P1357
RS5043	S51	LS47	15.000	23.250†	8.250	NONE	P1357
RS5044	S51	LS47	15.750	24.750†	9.000	NONE	P1357
RS5045	L1	LS26	19.750	33.750	14.000	NONE	NONE
RS5046	L1	LS26	16.500	27.000	10.500	NONE	NONE
RS5047	L1	LS26	18.625	31.375	12.750	NONE	NONE
RS5111	L1	L1	12.875	20.250†	7.375	NONE	NONE
RS5112	L1	L1	16.000	26.250†	10.250	NONE	NONE
RS5113	L1	L1	12.875	20.250†	7.375	NONE	P916
RS5114	L2	L2	15.125	26.625†	11.500	NONE	P939
RS5115	S42	L1	13.000	20.750†	7.750	NONE	P910, P1134
RS5116	L1	L1	14.875	24.000†	9.125	NONE	P916
RS5117	S42	L1	12.000	18.750†	6.750	NONE	P910, P1134
RS5118	L1	L1	14.000	22.250†	8.250	NONE	P912, P915, P1013
RS5119	L1	L1	11.750	18.000†	6.250	NONE	P916, P925
RS5120	L1	LS36	9.750	14.000†	4.250	NONE	P915, P953
RS5123	LS39	LS39	11.750	18.000†	6.250	NONE	NONE
RS5124	XP7	LS47	14.625	23.500†	8.875	NONE	NONE
RS5125	L1	LS26	14.000	22.250†	8.250	NONE	P920
RS5126	L1	LS26	16.000	26.250†	10.250	NONE	P920
RS5128	S42	XP4	13.000	20.875†	7.875	NONE	P1136
RS5129	XP12	L1	12.875	20.000†	7.125	NONE	NONE
RS5131	LS41	LS37	13.250	21.000†	7.750	NONE	NONE
RS5132	L1	L1	16.000	26.250†	10.250	NONE	Two P911
RS5134	L1	L1	19.000	32.625†	13.625	NONE	P915, P934
RS5135	S42	S42	12.125	19.625†	7.500	NONE	Two P1135
RS5136	S42	L1	11.250	17.375†	6.125	NONE	P910, P1134
RS5138	S42	LS26	13.000	20.750†	7.750	NONE	P1135
RS5139	S42	LS26	12.000	18.750†	6.750	NONE	P864, P1135
RS5140	L3	LS38	12.875	20.250†	7.375	NONE	P120
RS5141	L1	L1	10.125	14.625†	4.500	NONE	NONE
RS5143	L3	L3	15.500	25.250†	9.750	NONE	P119
RS5144	L3	L3	14.125	22.375†	8.250	NONE	P119
RS5145	S42	LS82	9.375	13.375†	4.000	NONE	P1134
RS5146	S42	XP5	9.375	14.125†	4.750	NONE	P1134
RS5147	LS74	LS74	14.750	23.125†	8.375	NONE	NONE
RS5150	LS77	LS39	11.500	16.125†	4.625	NONE	NONE
RS5151	LS41	LS37	12.125	18.750†	6.625	NONE	NONE
RS5152	LS77	LS39	11.625	17.750†	6.125	NONE	NONE
RS5154	S42	XP4	9.250	13.625†	4.375	NONE	P1135
RS5155	LS28	LS26	11.750	18.000†	6.250	NONE	NONE

† Bumper Stop Unit. Dimension shown at Bumper Contact.

Specifications

All listed specifications are for convenience only and are subject to change without notice. Specifications are not intended for design of custom applications.

NOTE: Internal extension bumper may reduce perceived extended length by 1/2".
Extended and collapsed length dimensions shown for RS5000 shocks, others may vary slightly.

PART NO.	MOUNTING CODES		LENGTHS		TRAV.	DUST SHIELD	PARTS PACK
	UPPER	LOWER	COMP.	EXT.			
RANCHO RS5000 Shock Absorber — Continued							
RS5156	S42	XP5	8.500	12.125†	3.625	NONE	P1134
RS5157	L3	S51	13.625	22.000†	8.375	NONE	P967, P1167
RS5158	S42	L3	13.000	20.875†	7.875	NONE	P120, P1134
RS5159	S12	S12	12.750	21.000†	8.250	NONE	P969
RS5160	S42	S42	10.750	16.875†	6.125	NONE	Two P1134
RS5165	LS26	LS26	14.000	22.250†	8.250	NONE	NONE
RS5166	S42	XP5	9.500	13.750†	4.250	NONE	P1134
RS5167	S42	L1	10.250	15.250†	5.000	NONE	P1134
RS5168	S42	LS38	15.250	25.250†	10.000	NONE	P1135
RS5169	L3	L3	12.750	19.625†	6.875	NONE	P119, P967
RS5179	S42	L1	13.875	22.250†	8.375	NONE	P920, P1135
RS5180	L3	L3	13.625	21.500†	7.875	NONE	P119
RS5181	XP8	LS39	14.000	22.250†	8.250	NONE	NONE
RS5182	S42	S42	11.375	18.125†	6.750	NONE	Two P1134
RS5183	S42	L3	11.000	16.750†	5.750	NONE	P120, P1134
RS5184	L3	L3	13.000	20.250†	7.250	NONE	P119
RS5185	XP7	LS26	15.250	25.375	10.125	NONE	P941
RS5186	S42	L1	13.375	21.500†	8.125	NONE	P1134
RS5187	S42	L3	13.000	20.750†	7.750	NONE	P120, P1134
RS5188	S42	LS23	8.375	12.500	4.125	NONE	P1134
RS5190	XP7	LS47	15.875	26.250†	10.375	NONE	NONE
RS5193	XP7	LS47	14.125	22.875†	8.750	NONE	NONE
RS5194	L1	LS25	14.375	23.250†	8.875	NONE	NONE
RS5195	S51	LS47	9.500	13.750†	4.250	NONE	P1167
RS5197	S51	LS47	13.750	21.250†	7.500	NONE	P1167
RS5198	LS47	LS47	15.000	24.375†	9.375	NONE	NONE
RS5199	S42	XP8	9.000	13.375	4.375	NONE	P1135
RS5201	S42	S42	11.500	18.500†	7.000	NONE	Two P1135
RS5202	L3	L3	14.750	23.625†	8.875	NONE	P575
RS5203	L1	LS82	12.375	19.125†	6.750	NONE	NONE
RS5204	S42	S42	11.375	18.500†	7.125	NONE	Two P1134
RS5205	L1	L1	13.875	22.250†	8.375	NONE	NONE
RS5206	S42	L3	13.625	21.625†	8.000	NONE	P120, P1134
RS5207	S51	S51	14.250	23.375†	9.125	NONE	Two P1167
RS5208	S51	L3	14.000	22.500†	8.500	NONE	P120, P1167
RS5213	S42	LS24	11.750	18.375†	6.625	NONE	P1134
RS5214			9.700	14.990†	5.290	NONE	P1134
RS5215	LS78	L3	12.750	19.750†	7.000	NONE	P120
RS5221	S51	LS47	14.500	23.625†	9.125	NONE	P1167
RS5222	S42	XP5	9.000	13.625	4.625	NONE	P1134
RS5223	S42	LS24	9.000	13.000†	4.000	NONE	P1134
RS5225	LS47	LS47	16.250	26.875†	10.625	NONE	NONE
RS5226	L3	L3	13.125	20.375	7.250	NONE	P119
RS5227	XP7	LS47	17.375	28.875†	11.500	NONE	NONE
RS5229	S42	XP4	13.750	18.250†	4.500	NONE	P941, P1135
RS5233	S42	LS39	9.750	14.250†	4.500	NONE	P1136
RS5234	S42	LS26	15.750	27.000	11.250	NONE	P1135
RS5235	S51	XP5	10.250	14.875†	4.625	NONE	P1167
RS5236	S42	LS26	14.375	24.000	9.625	NONE	P1135
RS5237	S42	LS39	11.625	18.000†	6.375	NONE	P1136
RS5238	S42	LS26	16.500	28.500	12.000	NONE	P1136
RS5239	S42	XP4	14.375	23.750†	9.375	NONE	P1136
RS5240	XP12	L1	12.250	19.000†	6.750	NONE	P920
RS5241	XP12	LS37	13.500	21.500†	8.000	NONE	P920
RS5244	LS77	LS39	13.000	19.000†	6.000	NONE	NONE
RS5246	LS26	LS26	14.250	23.000†	8.750	NONE	NONE
RS5247	S42	LS43	14.500	24.125	9.625	NONE	P1135

† Bumper Stop Unit. Dimension shown at Bumper Contact.

Rancho only engineers its shock absorbers for the applications listed in this catalog. Misapplication of Rancho shock absorbers will result in reduced handling and braking ability and voids warranty. Product Specifications Subject To Change Without Notice.

NOTE: Internal extension bumper may reduce perceived extended length by 1/2".
 Extended and collapsed length dimensions shown for RS5000 shocks, others may vary slightly.

PART NO.	MOUNTING CODES		LENGTHS			DUST SHIELD	PARTS PACK
	UPPER	LOWER	COMP.	EXT.	TRAV.		
RANCHO RS5000 Shock Absorber — Continued							
RS5248	LS28	LS28	15.375	24.625†	9.250	NONE	NONE
RS5251	S42	LS43	15.750	27.000	11.250	NONE	P1134
RS5254	L1	LS26	18.125	30.750	12.625	NONE	NONE
RS5255	S42	XP4	15.750	26.375†	10.625	NONE	P1136
RS5256	XP12	L1	15.000	24.625†	9.625	NONE	P920
RS5259	L1	LS25	13.500	21.500†	8.000	NONE	NONE
RS5260	LS79	LS25	13.500	21.500†	8.000	NONE	NONE
RS5261	L1	LS26	19.125	33.000	13.875	NONE	NONE
RS5262	LS47	LS47	15.750	25.625†	9.875	NONE	NONE
RS5263	S42	XP5	9.875	14.500†	4.625	NONE	P1135
RS5264	L1	LS53	15.375	24.375†	9.000	NONE	NONE
RS5265	S42	SPEC	10.875	15.375†	4.500	NONE	P1135
RS5267	L1	LS53	14.250	22.750†	8.500	NONE	NONE
RS5268	S42	SPEC	13.875	20.750†	6.875	NONE	P1269
RS5269	LS47	LS47	16.500	27.250†	10.750	NONE	NONE
RS5272	S51	L1	10.250	15.000†	4.750	NONE	NONE
RS5273	L1	LS53	16.625	28.000	11.375	NONE	NONE
RS5274	LS47	LS47	16.000	26.000†	10.000	NONE	NONE
RS5279	S51	XP12	10.750	16.375†	5.625	NONE	P1167
RS5281	S51	XP12	9.625	14.125†	4.500	NONE	P1167
RS5282	S51	LS47	11.000	15.875†	4.875	NONE	P1167
RS5283	S51	LS47	12.500	19.150†	6.650	NONE	P1167
RS5284	LS52	LS28	14.000	22.125†	8.125	NONE	NONE
RS5285	LS39	LS39	15.375	25.000†	9.625	NONE	NONE
RS5286	LS39	LS39	16.500	27.250†	10.750	NONE	NONE
RS5288	S51	LS42	12.500†	15.125†	2.625	NONE	P1167
RS5289	S51	LS42	15.500†	21.625†	6.125	NONE	P1167
RS5295	S51	LS42	10.375	15.125†	4.750	NONE	P1167
RS5296	S51	LS42	13.375	21.625†	8.250	NONE	P1167
RS5297	LS47	LS47	18.000	30.375†	12.375	NONE	NONE
RS5298	LS38	LS38	10.875	16.750	5.875	NONE	NONE
RS5299	XP7	LS47	13.375	21.000†	7.625	Yes	NONE
RS5300	S42	LS21	10.000	14.500†	4.500	Yes	P1134
RS5301	XP7	LS47	14.750	23.000†	8.250	Yes	NONE
RS5304	LS92	LS91	16.500	22.250†	5.750	NONE	NONE
RS5329	S51	LS38	15.500	25.375	9.500	NONE	P1167
RS5331	S51	LS38	16.125	37.500	11.125	NONE	P1167
RS5332	SPEC	LS38	16.750	28.500	11.375	NONE	NONE
RS5601	L1	L1	12.250	19.750†	7.500	NONE	NONE
RS5602	S42	XP1	8.875	13.375†	4.500	NONE	P1134
RS5604	L1	S42	11.875	19.250†	7.375	NONE	P1134
RS5605	S42	LS23	8.875	13.750	4.875	NONE	P1134
RS5606	S42	LS37	9.750	15.000	5.250	NONE	P1135
RS5607	S41	S41	12.250	19.625†	7.375	NONE	Two P1134
RS5609	S42	XP5	9.125	14.375	5.250	NONE	P1134
RS5757	STRUT		13.500	18.125	4.500	NONE	NONE
RS5758	S51	LS78	17.750	23.500	5.750	NONE	P1167
RS5761	S51	LS43	13.500	18.125†	4.625	NONE	P1167
RS5762	S51	LS43	13.625	18.250†	4.625	Yes	P1167
RS5763	S51	LS44	13.500	16.125†	2.625	Yes	P1167
RS5764	S12	SPEC	9.750	13.875†	4.125	Yes	NONE
RS5766	S51	LS44	13.625	18.000†	4.375	Yes	P1167
RS5767	S12	LS95	17.375	21.625†	4.250	NONE	P1388
RS5770	S51	LS43	10.875	16.000†	5.125	Yes	P1167
RS5773	S51	LS92	15.125	19.000†	3.875	Yes	P1365
RS5774	S12	LS95	15.750	20.625†	4.875	NONE	P1388
RS5775	STRUT		16.375	12.500	3.875	NONE	P762

† Bumper Stop Unit. Dimension shown at Bumper Contact.

Specifications

All listed specifications are for convenience only and are subject to change without notice. Specifications are not intended for design of custom applications.

NOTE: Internal extension bumper may reduce perceived extended length by 1/2".
Extended and collapsed length dimensions shown for RS5000 shocks, others may vary slightly.

PART NO.	MOUNTING CODES		LENGTHS			DUST SHIELD	PARTS PACK
	UPPER	LOWER	COMP.	EXT.	TRAV.		
RANCHO RS5000 Shock Absorber — Continued							
RS5776	STRUT		16.375	12.500	3.875	NONE	P762
RS5784	S12	SPEC	13.875	18.000	3.875	NONE	P1426, P1415
RS5786	S12	SPEC	18.750	23.000	3.875	NONE	P1426, P1415
RANCHO RS9000X Shock Absorber							
RS99001	L1	L1	13.625	20.750†	7.125	NONE	P816, P976
RS99005	L1	L2	17.500	28.625†	11.125	NONE	P934
RS99006	L1	L1	11.750	17.375†	5.625	NONE	P915, P927, P1057
RS99007	L1	LS26	15.000	23.750†	8.750	NONE	NONE
RS99008	L1	L1	13.875	21.500†	7.625	NONE	P920, P1020
RS99009	S42	LS38	16.000	26.125†	10.125	NONE	P1192
RS99010	L1	L1	16.125	26.000†	9.875	NONE	P920, P1057
RS99012	L1	L1	19.375	32.250†	12.875	NONE	P915, P934
RS99014	S42	S42	15.000	24.625†	9.625	NONE	Two P1192
RS99017	S42	L1	15.500	25.125†	9.625	NONE	P829, P1192
RS99028	L1	L1	16.875	28.125	11.250	NONE	P915, P934
RS99029	S42	LS26	10.375	14.500†	4.125	NONE	P1192
RS99034	L1	L1	20.125	34.000†	13.875	NONE	P915, P1013
RS99036	L1	L1	21.125	36.125†	15.000	NONE	P915, P1013
RS99039	S42	L1	10.375	14.500†	4.125	NONE	P1013, P1192
RS99040	S42	LS23	14.000	23.375†	9.375	NONE	P1192
RS99042	S51	LS47	13.750	20.750†	7.000	NONE	P1356
RS99043	S51	LS47	15.000	23.250†	8.250	NONE	P1356
RS99044	S51	LS47	15.750	24.750†	9.000	NONE	P1356
RS99045	L1	LS26	19.750	33.750	14.000	NONE	NONE
RS99046	L1	LS26	16.375	27.000	10.625	NONE	NONE
RS99047	L1	LS27	18.500	31.375	12.875	NONE	NONE
RS99048	S51	LS47	16.750	26.750†	10.000	NONE	P1356
RS99050	L1	LS26	18.000	29.125†	11.125	NONE	NONE
RS99055	S51	LS42	17.625†	23.000†	5.375	NONE	P1271
RS99056	LS47	LS47	19.250	32.000†	12.750	NONE	NONE
RS99057	S42	LS47	14.875	23.000†	8.125	NONE	P1192
RS99058	LS47	LS47	18.125	29.750†	11.625	NONE	NONE
RS99059	LS77	LS39	15.500	24.375†	8.875	NONE	NONE
RS99060	XP7	LS47	18.500	30.500†	12.000	NONE	NONE
RS99061	S42	XP4	16.250	26.625†	10.375	NONE	P1270
RS99062	XP12	LS24	15.750	25.250†	9.500	NONE	NONE
RS99111	L1	L1	13.125	20.000†	6.875	NONE	NONE
RS99112	L1	L1	16.125	26.000†	9.875	NONE	P913, P915, P1013
RS99113	L1	L1	13.125	20.000†	6.875	NONE	P916
RS99114	L2	L2	15.375	24.250†	8.875	NONE	P939
RS99115	S42	L1	13.250	20.625†	7.375	NONE	P910, P1192
RS99116	L1	L1	15.000	23.750†	8.750	NONE	P916, P1013
RS99117	S42	L1	12.250	18.625†	6.375	NONE	P910, P1192
RS99118	L1	L1	14.250	22.125†	7.875	NONE	P910, P912, P1013
RS99119	L1	L1	11.625	17.375†	5.750	NONE	P916
RS99120	L1	L1	9.750	13.500†	3.750	NONE	P915, P916
RS99123	LS39	LS39	11.625	17.375†	5.750	NONE	NONE
RS99124	XP7	LS47	15.000	23.750†	8.750	NONE	NONE
RS99125	L1	LS26	14.375	22.250†	7.875	NONE	NONE
RS99126	L1	LS26	16.125	26.000†	9.875	NONE	NONE
RS99128	S42	XP4	13.250	20.500†	7.250	NONE	P941, P1270
RS99129	XP12	L1	13.125	19.875†	6.750	NONE	NONE
RS99136	S42	L1	11.375	16.750†	5.375	NONE	P910, P1013, P1192
RS99138	S42	LS26	13.250	20.625†	7.375	NONE	P1192
RS99143	L3	L3	15.875	25.000†	9.125	NONE	NONE
RS99144	L3	L3	14.250	21.875†	7.625	NONE	NONE
RS99145	S42	LS82	9.625	13.375†	3.750	NONE	P1192

† Bumper Stop Unit. Dimension shown at Bumper Contact.

Rancho only engineers its shock absorbers for the applications listed in this catalog. Misapplication of Rancho shock absorbers will result in reduced handling and braking ability and voids warranty. Product Specifications Subject To Change Without Notice.

NOTE: Internal extension bumper may reduce perceived extended length by 1/2".
 Extended and collapsed length dimensions shown for RS5000 shocks, others may vary slightly.

PART NO.	MOUNTING CODES		LENGTHS			DUST SHIELD	PARTS PACK
	UPPER	LOWER	COMP.	EXT.	TRAV.		
RANCHO RS900X Shock Absorber — Continued							
RS99147	LS74	LS74	14.875	23.000†	8.125	NONE	NONE
RS99150	LS77	LS39	11.500	15.750†	4.250	NONE	NONE
RS99151	L1	L1	12.375	18.500†	6.125	NONE	P976
RS99152	LS77	LS39	12.250	17.875†	5.625	NONE	NONE
RS99155	LS28	LS26	11.625	17.375†	5.750	NONE	NONE
RS99156	S42	XP5	8.750	11.625†	2.875	NONE	P1192
RS99157	L3	S51	14.000	22.000†	8.000	NONE	P967, P1271
RS99158	S42	L3	13.375	20.750†	7.375	NONE	P1192
RS99159	S12	S12	13.000	21.000†	8.000	NONE	P969
RS99165	L1	L1	14.375	22.250†	7.875	NONE	P1059
RS99166	S42	XP5	9.750	13.750†	4.000	NONE	P1192
RS99168	S42	LS38	15.500	25.125†	9.625	NONE	P1192
RS99179	S42	L1	14.000	22.375†	8.375	NONE	P974, P1192
RS99180	L3	L3	13.875	21.125†	7.250	NONE	NONE
RS99185	XP7	LS26	16.125	26.000†	9.875	NONE	P941
RS99186	S42	L1	13.125	20.375†	7.250	NONE	P974
RS99187	S42	L3	13.250	20.500†	7.250	NONE	P1192
RS99188	S42	LS23	8.875	12.375	3.500	NONE	P1192
RS99190	XP7	LS47	16.375	26.250†	9.875	NONE	NONE
RS99193	XP7	LS47	14.625	22.875†	8.250	NONE	NONE
RS99194	L1	LS25	14.625	23.125†	8.500	NONE	NONE
RS99195	S51	LS47	9.875	13.750†	3.875	NONE	P1271
RS99197	S51	LS47	14.000	21.375†	7.375	NONE	P1271
RS99198	LS47	LS47	15.750	25.000†	9.250	NONE	NONE
RS99201	S42	S42	11.875	18.500†	6.625	NONE	Two P1192
RS99202	L3	L3	15.125	23.625†	8.500	NONE	P888
RS99204	S42	S42	11.625	17.875†	6.250	NONE	Two P1192
RS99205	L1	L1	14.250	22.125†	7.875	NONE	NONE
RS99207	S51	S51	14.500	23.250†	8.750	NONE	Two P1271
RS99208	S51	L3	14.625	23.250†	8.625	NONE	P1271
RS99213	S42	LS82	12.000	18.125†	6.125	NONE	P1192
RS99214	S42	LS23	10.375	14.500†	4.125	NONE	P1192
RS99215	LS78	L3	12.875	19.125†	6.250	NONE	NONE
RS99221	S51	LS47	15.000	23.250†	8.250	NONE	P1271
RS99223	S42	LS24	9.375	13.000†	3.625	NONE	P1192
RS99226	L3	L3	13.000	19.500†	6.500	NONE	NONE
RS99227	XP7	LS47	16.750	27.250†	10.500	NONE	NONE
RS99229	S42	XP4	13.875	18.000†	4.125	NONE	P941, P1192
RS99233	S51	LS39	10.250	14.500†	4.250	NONE	P1271
RS99234	S42	LS26	16.125	27.000	10.875	NONE	P1192
RS99235	S51	XP5	10.500	14.875†	4.375	NONE	P1271
RS99236	S42	LS26	14.625	23.875	9.250	NONE	P1192
RS99237	S51	LS39	12.000	18.000†	6.000	NONE	P1271
RS99238	S42	LS26	17.250	28.625†	11.375	NONE	P1192
RS99239	S42	XP4	14.500	23.125†	8.625	NONE	P1192
RS99240	XP12	LS24	12.750	19.125†	6.375	NONE	NONE
RS99241	XP12	LS24	13.625	20.875†	7.250	NONE	NONE
RS99243	S42	LS43	17.250	28.625†	11.375	NONE	P1192
RS99244	LS77	LS39	14.125	21.750†	7.625	NONE	NONE
RS99246	LS26	LS26	14.625	23.125†	8.500	NONE	NONE
RS99247	S42	LS43	14.625	23.875	9.250	NONE	P1192
RS99248	LS28	LS28	15.125	24.000†	8.875	NONE	NONE
RS99251	S42	LS43	16.125	27.000	10.875	NONE	P1192
RS99254	L1	LS26	18.250	30.750	12.500	NONE	NONE
RS99255	S42	XP4	15.875	25.875†	10.000	NONE	P1270
RS99256	XP12	LS24	15.125	24.000†	8.875	NONE	NONE
RS99259	L1	LS25	13.875	21.500†	7.625	NONE	NONE

† Bumper Stop Unit. Dimension shown at Bumper Contact.

Specifications

All listed specifications are for convenience only and are subject to change without notice. Specifications are not intended for design of custom applications.

NOTE: Internal extension bumper may reduce perceived extended length by 1/2".
Extended and collapsed length dimensions shown for RS5000 shocks, others may vary slightly.

PART NO.	MOUNTING CODES		LENGTHS			DUST SHIELD	PARTS PACK
	UPPER	LOWER	COMP.	EXT.	TRAV.		
RANCHO RS9000X Shock Absorber — Continued							
RS99260	LS29	LS25	13.875	21.500†	7.625	NONE	NONE
RS99261	L1	LS26	19.250	32.875	13.625	NONE	NONE
RS99262	LS47	LS47	15.125	23.875†	8.750	NONE	NONE
RS99263	S42	XP5	10.125	14.375†	4.250	NONE	P1192
RS99264	L1	LS26	15.625	24.375†	8.750	NONE	NONE
RS99265	S42	SPEC	11.000	15.250†	4.250	NONE	P1192
RS99266	XP7	LS26	16.875	28.125	11.250	NONE	NONE
RS99267	L1	LS26	14.500	22.250†	7.750	NONE	NONE
RS99268	S42	SPEC	13.875	20.750†	6.875	NONE	P1192
RS99269	LS47	LS47	16.875	27.250†	10.375	NONE	NONE
RS99270	S51	XP5	13.375	20.750†	7.375	NONE	P1271
RS99272	S51	L1	10.375	14.875†	4.500	NONE	P1271
RS99273	L1	LS26	16.875	28.125	11.250	NONE	NONE
RS99274	LS47	LS47	16.375	26.250†	9.875	NONE	NONE
RS99275	XP7	LS26	19.375	32.875	13.500	NONE	NONE
RS99276	S51	LS47	11.750	17.500†	5.750	NONE	P1271
RS99278	XP7	LS26	15.500	25.125	9.625	NONE	NONE
RS99279	S51	XP12	11.000	13.375†	2.375	NONE	P1356
RS99280	S51	LS47	13.750	20.750†	7.000	NONE	P1271
RS99281	S51	XP12	9.875	14.125†	4.250	NONE	P1271
RS99282	S51	LS47	11.375	15.875†	4.500	NONE	P1271
RS99283	S51	LS47	13.000	19.250†	6.250	NONE	P1271
RS99284	LS30	LS28	14.125	22.000†	7.875	NONE	NONE
RS99286	LS39	LS39	17.250	28.250†	11.000	NONE	NONE
RS99287	LS39	LS39	18.500	30.500†	12.000	NONE	NONE
RS99288	S51	LS42	12.750†	15.250†	2.500	NONE	P1271
RS99289	S51	LS42	15.875†	21.625†	5.750	NONE	P1271
RS99295	S51	LS42	10.625	15.250†	4.625	NONE	P1271
RS99296	S51	LS42	13.750	21.625†	7.875	NONE	P1271
RS99297	LS47	LS47	18.500	30.500†	12.000	NONE	NONE
RS99301	XP7	LS47	14.625	23.000†	8.375	NONE	NONE
RS99303	LS47	LS47	15.375	24.125†	8.750	NONE	NONE
RS99304	LS47	LS44	16.875	27.250†	10.375	NONE	NONE
RS99762	S51	LS43	13.625	18.250†	4.625	Yes	P1356
RS99763	S51	LS44	13.500	18.125†	4.625	Yes	P1167
RS99764	S15	SPEC	7.625	12.125†	4.500	Yes	P1372
RS99766	S51	LS43	13.625	18.000†	4.375	Yes	P1356
RS99767	S15	SPEC	16.625	21.625†	5.000	NONE	P1388
RS99768	S15	SPEC	18.125	23.125†	5.000	NONE	P1381
RS99769	S15	SPEC	21.375	26.375†	5.000	NONE	P1388
RS99771	S51	LS92	11.000	14.750†	3.750	Yes	P1356
RS99772	S51	LS92	11.625	16.375†	4.750	NONE	P1356
RS99773	S51	LS92	15.125	19.000†	3.875	Yes	P1356
RS99774	S15	LS95	17.375	21.625†	4.250	NONE	P1388
RANCHO RSX17000 Shock Absorber							
RSX17000	LS39	LS39	11.125	16.500†	5.375	NONE	NONE
RSX17001	XP7	LS47	14.625	24.000	9.375	NONE	NONE
RSX17002	L2	L2	13.250	21.125	7.875	NONE	NONE
RSX17003	LS39	L2	15.875	26.375	10.500	NONE	NONE
RSX17004	LS28	LS28	15.375	24.625†	9.250	NONE	NONE
RSX17005	L1	L1	11.875	18.125	6.250	NONE	P1265
RSX17006	L1	L1	12.750	19.625	6.875	NONE	NONE
RSX17007	L1	LS38	13.000	20.250†	7.250	NONE	P1267
RSX17008	L1	L1	13.250	21.125	7.875	NONE	P1266
RSX17009	L1	LS26	15.000	24.875	9.875	NONE	NONE
RSX17010	S42	LS26	10.000	14.750†	4.750	NONE	P1269
RSX17011	S42	LS43	14.375	24.000	9.625	NONE	P1269

† Bumper Stop Unit. Dimension shown at Bumper Contact.

Rancho only engineers its shock absorbers for the applications listed in this catalog. Misapplication of Rancho shock absorbers will result in reduced handling and braking ability and voids warranty. Product Specifications Subject To Change Without Notice.

NOTE: Internal extension bumper may reduce perceived extended length by 1/2".
 Extended and collapsed length dimensions shown for RS5000 shocks, others may vary slightly.

PART NO.	MOUNTING CODES		LENGTHS			DUST SHIELD	PARTS PACK
	UPPER	LOWER	COMP.	EXT.	TRAV.		
RANCHO RSX17000 Shock Absorber — Continued							
RSX17012	LS26	LS26	14.125	22.375†	8.250	NONE	NONE
RSX17013	L1	LS26	15.875	26.500	10.625	NONE	NONE
RSX17014	S51	XP5	10.250	14.875†	4.625	NONE	P1271
RSX17015	S42	LS26	14.375	24.000	9.625	NONE	P1269
RSX17016	L1	LS26	13.500	21.750	8.250	NONE	NONE
RSX17017	S42	L1	10.000	14.500†	4.500	NONE	P1269
RSX17018	XP7	LS26	15.375	25.375	10.000	NONE	P941
RSX17019	S42	L2	11.625	18.500	6.875	NONE	P1269
RSX17020	S42	LS39	9.875	14.375†	4.500	NONE	P1269
RSX17021	S42	XP4	13.750	18.250†	4.500	NONE	P941, P1269
RSX17022	L1	LS26	14.250	23.000	8.750	NONE	NONE
RSX17023	LS26	LS26	14.500	23.125†	8.625	NONE	NONE
RSX17024	S42	LS26	15.875	27.000	11.125	NONE	P1269
RSX17025	S42	LS26	10.625	15.875†	5.250	NONE	P1269
RSX17026	S42	LS26	10.250	15.000†	4.750	NONE	P1269
RSX17027	S42	LS43	16.125	27.625†	11.500	NONE	P1269
RSX17028	L1	LS26	14.125	22.375†	8.250	NONE	NONE
RSX17029	L1	LS26	14.375	23.125	8.750	NONE	P827
RSX17030	L1	LS26	16.125	26.375	10.250	NONE	P827
RSX17031	S51	LS47	9.750	13.875†	4.125	NONE	P1271
RSX17032	LS47	LS47	14.875	23.750†	8.875	NONE	NONE
RSX17033	S51	LS47	13.750	21.250†	7.500	NONE	P1271
RSX17036	S42	XP4	12.875	20.500†	7.625	NONE	P1270
RSX17037	L1	LS25	13.500	21.125†	7.625	NONE	NONE
RSX17038	S42	LS38	14.500	24.375	9.875	NONE	P1269
RSX17039	L1	LS38	12.125	18.375	6.250	NONE	NONE
RSX17040	XP12	LS37	12.750	19.625†	6.875	NONE	NONE
RSX17041	S42	XP4	13.250	21.125†	7.875	NONE	P1270
RSX17043	XP12	L1	12.875	19.750†	6.875	NONE	NONE
RSX17044	LS77	LS39	11.250	16.625†	5.375	NONE	NONE
RSX17045	XP7	LS47	16.125	26.375†	10.250	NONE	NONE
RSX17046	S42	XP5	9.500	13.750†	4.250	NONE	P1268
RSX17047	XP7	LS47	15.500	25.250†	9.750	NONE	NONE
RSX17048	XP7	LS47	14.875	23.625†	8.750	NONE	NONE
RSX17049	XP7	LS47	14.125	22.375†	8.250	NONE	NONE
RSX17050	S42	XP4	8.500	12.250	3.750	NONE	P1268
RSX17051	L1	LS36	10.000	14.750	4.750	NONE	P19
RSX17052	LS26	LS26	13.750	21.750†	8.000	NONE	NONE
RSX17053	S42	LS26	11.625	18.500	6.875	NONE	P864, P1269
RSX17054	S42	LS26	10.000	14.500†	4.500	NONE	P1269
RSX17058	LS40	LS40	13.250	21.000	7.750	NONE	NONE
RSX17060	S42	XP4	9.000	13.375	4.375	NONE	P1268
RSX17061	LS37	LS37	11.750	18.125	6.375	NONE	P816
RSX17062	L1	LS47	14.125	22.750	8.625	NONE	P19
RSX17065	L1	L1	14.375	23.000	8.625	NONE	NONE
RSX17068	S42	SPEC	10.875	15.375†	4.500	NONE	P1269
RSX17069	LS47	LS47	15.625	25.375†	9.750	NONE	NONE
RSX17070	S42	XP5	9.875	14.500†	4.625	NONE	P1268
RSX17071	L1	LS26	14.250	22.750†	8.500	NONE	NONE
RSX17072	L1	LS26	19.375	30.500†	11.125	NONE	NONE
RSX17073	LS29	LS25	13.875	21.750†	7.875	NONE	NONE
RSX17075	L1	LS26	16.625	28.000	11.375	NONE	NONE
RSX17077	XP7	LS26	16.875	28.250	11.375	NONE	NONE
RSX17079	S51	LS42	10.375	15.125†	4.750	NONE	P1271
RSX17080	LS52	LS28	13.875	22.125†	8.250	NONE	NONE
RSX17081	LS28	LS29	14.625	23.250†	8.625	Yes	P1374
RSX17082	LS28	LS29	14.625	22.375†	7.750	Yes	P1374

† Bumper Stop Unit. Dimension shown at Bumper Contact.

Specifications

All listed specifications are for convenience only and are subject to change without notice. Specifications are not intended for design of custom applications.

NOTE: Internal extension bumper may reduce perceived extended length by 1/2".
Extended and collapsed length dimensions shown for RS5000 shocks, others may vary slightly.

PART NO.	MOUNTING CODES		LENGTHS			DUST SHIELD	PARTS PACK
	UPPER	LOWER	COMP.	EXT.	TRAV.		
RANCHO RSX17000 Shock Absorber — Continued							
RSX17121	LS52	LS30	14.750	23.250†	8.500	NONE	NONE
RSX17122	LS74	LS52	15.125	24.250†	9.125	NONE	NONE
RSX17123	S42	LS12	8.250	11.875	3.625	NONE	P1268
RSX17124	L1	L1	13.875	22.500	8.625	NONE	NONE
RSX17128	LS92	LS91	15.125	24.125†	9.000	NONE	NONE
RSX17129	LS92	LS91	14.500	22.875†	8.375	NONE	NONE
RSX17130	LS91	LS91	11.875	17.625†	5.750	Yes	NONE
RSX17131	S51	LS54	14.000	22.250†	8.250	Yes	P1167, P1336
RSX17301	L1	LS26	15.000	24.625	9.625	NONE	NONE
RSX17302	S42	LS26	12.000	18.750†	6.750	NONE	P1269
RSX17303	S42	L1	14.000	22.875	8.875	NONE	P1269
RSX17304	L2	L2	15.250	25.000	9.750	NONE	NONE
RSX17305	S42	LS26	11.375	17.125†	5.750	NONE	P1269
RSX17306	LS28	LS28	16.250	26.625†	10.375	NONE	NONE
RSX17308	S51	LS47	14.750	23.250†	8.500	NONE	P1271
RSX17309	LS39	LS39	13.750	22.375	8.625	NONE	NONE
RSX17310	L1	LS26	16.000	26.875	10.875	NONE	NONE
RSX17311	S42	LS26	17.500	29.125	11.625	NONE	P1269
RSX17312	L1	LS26	14.000	22.750	8.750	NONE	NONE
RSX17313	S42	L1	11.125	16.875†	5.750	NONE	P1269
RSX17314	XP7	LS26	16.125	26.875	10.750	NONE	NONE
RSX17315	XP7	LS47	17.250	28.750†	11.500	NONE	NONE
RSX17316	LS77	LS39	13.750	21.625†	7.875	NONE	NONE
RSX17317	S42	XP4	14.500	23.750†	9.250	NONE	P1270
RSX17318	XP12	L1	14.375	22.875†	8.500	NONE	NONE
RSX17319	L1	L1	12.375	19.625	7.250	NONE	P1265
RSX17320	L1	L1	14.000	22.250	8.250	NONE	NONE
RSX17321	L1	LS38	13.000	20.750	7.750	NONE	P1267
RSX17322	L1	L1	14.000	22.625	8.625	NONE	P1266
RSX17324	L1	LS25	14.375	22.875†	8.500	NONE	NONE
RSX17326	XP12	LS37	13.500	21.000†	7.500	NONE	NONE
RSX17327	S42	LS38	15.250	25.250†	10.000	NONE	P1269
RSX17328	L1	LS38	14.000	22.250†	8.250	NONE	NONE
RSX17329	S42	LS39	11.750	18.000†	6.250	NONE	P1269
RSX17330	LS39	L2	17.500	29.000	11.500	NONE	NONE
RSX17331	S42	LS43	18.000	29.125	11.125	NONE	P1269
RSX17332	LS26	LS26	15.875	25.875†	10.000	NONE	NONE
RSX17337	S42	SPEC	13.875	20.750†	6.875	NONE	P1269
RSX17338	LS47	LS47	17.000	27.875†	10.875	NONE	NONE
RSX17339	S42	XP4	15.750	26.125†	10.375	NONE	P1270
RSX17340	XP12	LS37	15.125	24.375†	9.250	NONE	NONE
RSX17341	L1	LS26	15.375	24.375†	9.000	NONE	NONE
RSX17342	L1	LS26	19.125	32.375†	13.250	NONE	NONE
RSX17344	S51	XP5	14.500	20.750†	6.250	NONE	P1271
RSX17345	S42	XP4	12.875	20.375†	7.500	NONE	P1270
RSX17346	LS47	LS47	15.875	25.750†	9.875	NONE	NONE
RSX17501	STRUT		16.750	22.375†	5.625	NONE	NONE
RSX17502	STRUT		16.750	22.375†	5.625	NONE	NONE
RSX17503	STRUT		16.000	22.625†	6.625	NONE	NONE
RSX17504	STRUT		16.000	22.625†	6.625	NONE	NONE
RSX17505	S12	SPEC	9.750	13.875†	4.125	Yes	NONE
RSX17506	S51	LS93	18.250†	19.000†	0.750	Yes	P1366
RSX17507	S51	LS94	15.000†	19.250†	4.250	Yes	P1366
RSX17508	S51	LS43	13.625	18.250†	4.625	Yes	P1367
RSX17509	S51	LS44	13.625	18.000†	4.375	Yes	P1357
RSX17510	STRUT		16.000	22.625†	6.625	NONE	NONE
RSX17511	STRUT		16.000	22.625†	6.625	NONE	NONE

† Bumper Stop Unit. Dimension shown at Bumper Contact.

Rancho only engineers its shock absorbers for the applications listed in this catalog. Misapplication of Rancho shock absorbers will result in reduced handling and braking ability and voids warranty. Product Specifications Subject To Change Without Notice.

NOTE: Internal extension bumper may reduce perceived extended length by 1/2".
 Extended and collapsed length dimensions shown for RS5000 shocks, others may vary slightly.

PART NO.	MOUNTING CODES		LENGTHS			DUST SHIELD	PARTS PACK
	UPPER	LOWER	COMP.	EXT.	TRAV.		
RANCHO RSX17000 Shock Absorber — Continued							
RSX17512	S15	SPEC	11.125	16.125†	5.000	NONE	NONE
RSX17513	S51	LS44	13.500	16.125†	2.625	Yes	P1357
RSX17515	S51	LS92	11.000	14.875†	3.875	Yes	P1365
RSX17522	STRUT		14.125	20.375	6.250	NONE	NONE
RSX17523	S51	LS78	15.875	22.375	5.000	NONE	P1167
RSX17524	STRUT		14.500	21.125	6.625	NONE	P1450
RSX17525	STRUT		14.500	21.125	6.625	NONE	P1450
RSX17526	STRUT		11.000	15.750	4.750	NONE	P1486
RANCHO RS5400 PREMIUM Steering Stabilizer							
RS5401	L1	L1	12.125	19.250	7.125	NONE	P829, P837, P920
RS5402	S42	S42	12.000	20.125	8.125	NONE	Two P1134
RS5403	S42	S42	13.000	22.125	9.125	NONE	Two P1134
RS5404	L1	L1	14.375	23.875	9.500	NONE	P837, P920, P932
RS5405	S42	L1	12.625	21.625	9.000	NONE	P1134
RS5406	L1	L1	17.625	30.250	12.625	NONE	NONE
RS5407	L1	L1	12.000	19.625	7.625	NONE	P837, P953
RS5408	S42	S42	14.625	25.125	10.500	NONE	Two P1134
RS5409	LS5	LS24	12.750	20.450	7.700	NONE	P1326
RS5410	L1	LS38	14.500	24.375	9.875	NONE	P847
RS5411	L1	LS35	12.500	20.625	8.125	NONE	P1368
RS5412	L1	LS24	14.125	23.250	9.125	NONE	P1368
RS5413	S42	L1	15.625	27.375	11.750	NONE	P1135, P1385
RS5415	LS38	L1	16.125	27.875	11.750	NONE	P1385
RANCHO RS19000 PRO SERIES SHOCKS							
RS19012	L1	L1	19.375	32.250	12.875	NONE	P915 & P934
RS19034	L1	L1	20.125	34.000	13.875	NONE	P915 & P1013
RS19036	L1	L1	21.125	36.125	15.000	NONE	P915 & P1013
RS19044	S51	LS47	15.750	24.750	9.000	NONE	P1356
RS19045	L1	LS26	19.750	33.750	14.000	NONE	None
RS19237	S51	LS39	12.000	18.000	6.000	NONE	P1271
RS19238	S42	LS26	17.250	28.625	11.375	NONE	P1192
RS19255	S42	XP4	15.875	25.875	10.000	NONE	P1270
RS19256	XP12	LS24	15.125	24.000	8.875	NONE	None
RS19261	L1	LS26	19.250	32.875	13.625	NONE	None
RS19264	L1	LS26	15.625	24.375	8.750	NONE	None
RS19268	S42	SPEC	13.875	20.750	6.875	NONE	P1192
RS19269	LS47	LS47	16.875	27.250	10.375	NONE	None
RS19283	S51	LS47	13.000	19.250	6.250	NONE	P1271
RS19287	LS38	LS38	18.500	30.500	12.000	NONE	None
RS19289	S51	LS42	15.875	21.625	5.750	NONE	P1271
RS19297	LS47	LS47	18.500	30.500	12.000	NONE	None
RS19304	LS47	LS44	16.875	27.375	10.500	NONE	None
RS19331	S51	LS38	16.500	27.000	10.500	NONE	P1356
RS19332	XP12	LS38	16.375	27.000	10.625	NONE	None

† Bumper Stop Unit. Dimension shown at Bumper Contact.

Specifications

All listed specifications are for convenience only and are subject to change without notice. Specifications are not intended for design of custom applications.

NOTE: Internal extension bumper may reduce perceived extended length by 1/2".
Extended and collapsed length dimensions shown for RS5000 shocks, others may vary slightly.

PART NO.	MOUNTING CODES		LENGTHS			RESERVE TUBE	PARTS PACK
	UPPER	LOWER	COMP.	EXT.	TRAV.		
RANCHO RS9000XL SHOCK ABSORBERS							
RS999001	L1	L1	13.625	20.750†	7.125	2.38	P816, P976
RS999005	L1	L2	17.500	28.625†	11.125	2.38	P934
RS999008	L1	L1	13.875	21.500†	7.625	2.18	P920, P1020
RS999009	S42	LS38	16.000	26.125†	10.125	2.38	P1192
RS999010	L1	L1	16.125	26.000†	9.875	2.18	P920, P1057
RS999012	L1	L1	19.375	32.250†	12.875	2.75	P915, P934
RS999014	S42	S42	15.000	24.625†	9.625	2.18	Two P1192
RS999017	S42	L1	15.500	25.125†	9.625	2.18	P829, P1192
RS999028	L1	L1	16.875	28.125	11.250	2.75	P915, P934
RS999029	S42	LS26	10.375	14.500†	4.125	2.18	P1192
RS999034	L1	L1	20.125	34.000†	13.875	2.75	P915, P1013
RS999036	L1	L1	21.125	36.125†	15.000	2.75	P915, P1013
RS999039	S42	L1	10.375	14.500†	4.125	2.18	P1013, P1192
RS999040	S42	LS23	14.000	23.375†	9.375	2.18	P1192
RS999042	S51	LS47	13.750	20.750†	7.000	2.38	P1356
RS999043	S51	LS47	15.000	23.250†	8.250	2.38	P1356
RS999044	S51	LS47	15.750	24.750†	9.000	2.38	P1356
RS999045	L1	LS26	19.750	33.750	14.000	2.75	NONE
RS999046	L1	LS26	16.375	27.000	10.625	2.75	NONE
RS999047	L1	LS27	18.500	31.375	12.875	2.75	NONE
RS999048	S51	LS47	16.750	26.750†	10.000	2.38	P1356
RS999050	L1	LS26	18.000	29.125†	11.125	2.75	NONE
RS999055	S51	LS42	17.625†	23.000†	5.375	2.18	P1271
RS999056	LS47	LS47	19.250	32.000†	12.750	2.75	NONE
RS999057	S42	LS47	14.875	23.000†	8.125	2.38	P1192
RS999058	LS47	LS47	18.125	29.750†	11.625	2.75	NONE
RS999059	LS77	LS39	15.500	24.375†	8.875	2.18	NONE
RS999060	XP7	LS47	18.500	30.500†	12.000	2.75	NONE
RS999061	S42	XP4	16.250	26.625†	10.375	2.18	P1270
RS999062	XP12	LS24	15.750	25.250†	9.500	2.18	NONE
RS999112	L1	L1	16.125	26.000†	9.875	2.75	P913, P915, P1013
RS999113	L1	L1	13.125	20.000†	6.875	2.38	P916
RS999114	L2	L2	15.375	24.250†	8.875	2.38	P939
RS999115	S42	L1	13.250	20.625†	7.375	2.38	P910, P1192
RS999116	L1	L1	15.000	23.750†	8.750	2.75	P916, P1013
RS999117	S42	L1	12.250	18.625†	6.375	2.38	P910, P1192
RS999118	L1	L1	14.250	22.125†	7.875	2.38	P910, P912, P1013
RS999119	L1	L1	11.625	17.375†	5.750	2.38	P916
RS999120	L1	L1	9.750	13.500†	3.750	2.18	P915, P916
RS999123	LS39	LS39	11.625	17.375†	5.750	2.18	NONE
RS999124	XP7	LS47	15.000	23.750†	8.750	2.18	NONE
RS999126	L1	LS26	16.125	26.000†	9.875	2.18	NONE
RS999128	S42	XP4	13.250	20.500†	7.250	2.18	P941, P1270
RS999129	XP12	L1	13.125	19.875†	6.750	2.18	NONE
RS999136	S42	L1	11.375	16.750†	5.375	2.18	P910, P1013, P1192
RS999143	L3	L3	15.875	25.000†	9.125	2.18	NONE
RS999144	L3	L3	14.250	21.875†	7.625	2.18	NONE
RS999145	S42	LS82	9.625	13.375†	3.750	2.18	P1192
RS999150	LS77	LS39	11.500	15.750†	4.250	2.18	NONE
RS999151	L1	L1	12.375	18.500†	6.125	2.18	P976
RS999152	LS77	LS39	12.250	17.875†	5.625	2.18	NONE
RS999157	L3	S51	14.000	22.000†	8.000	2.18	P967, P1271
RS999159	S12	S12	13.000	21.000†	8.000	2.18	P969
RS999165	L1	L1	14.375	22.250†	7.875	2.75	P1059
RS999166	S42	XP5	9.750	13.750†	4.000	2.18	P1192
RS999168	S42	LS38	15.500	25.125†	9.625	2.38	P1192
RS999179	S42	L1	14.000	22.375†	8.375	2.18	P974, P1192

† Bumper Stop Unit. Dimension shown at Bumper Contact.

Rancho only engineers its shock absorbers for the applications listed in this catalog. Misapplication of Rancho shock absorbers will result in reduced handling and braking ability and voids warranty. Product Specifications Subject To Change Without Notice.

NOTE: Internal extension bumper may reduce perceived extended length by 1/2".
 Extended and collapsed length dimensions shown for RS5000 shocks, others may vary slightly.

PART NO.	MOUNTING CODES		LENGTHS			RESERVE TUBE	PARTS PACK
	UPPER	LOWER	COMP.	EXT.	TRAV.		
RANCHO RS9000XL SHOCK ABSORBERS — Continued							
RS999180	L3	L3	13.875	21.125†	7.250	2.18	NONE
RS999185	XP7	LS26	16.125	26.000†	9.875	2.18	P941
RS999187	S42	L3	13.250	20.500†	7.250	2.18	P1192
RS999188	S42	LS23	8.875	12.375	3.500	2.18	P1192
RS999190	XP7	LS47	16.375	26.250†	9.875	2.75	NONE
RS999194	L1	LS25	14.625	23.125†	8.500	2.18	NONE
RS999195	S51	LS47	9.875	13.750†	3.875	2.18	P1271
RS999197	S51	LS47	14.375	22.000†	7.625	2.38	P1271
RS999198	LS47	LS47	15.750	25.000†	9.250	2.75	NONE
RS999202	L3	L3	15.125	23.625†	8.500	2.18	P888
RS999207	S51	S51	14.500	23.250†	8.750	2.18	Two P1271
RS999208	S51	L3	14.625	23.250†	8.625	2.18	P1271
RS999213	S42	LS82	12.000	18.125†	6.125	2.18	P1192
RS999214	S42	LS23	10.375	14.500†	4.125	2.18	P1192
RS999215	LS78	L3	12.875	19.125†	6.250	2.18	NONE
RS999221	S51	LS47	15.375	23.875†	8.500	2.38	P1271
RS999223	S42	LS24	9.375	13.000†	3.625	2.18	P1192
RS999226	L3	L3	13.000	19.500†	6.500	2.18	NONE
RS999227	XP7	LS47	16.750	27.250†	10.500	2.75	NONE
RS999229	S42	XP4	13.875	18.000†	4.125	2.18	P941, P1192
RS999233	S51	LS39	10.250	14.500†	4.250	2.38	P1271
RS999234	S42	LS26	16.125	27.000	10.875	2.38	P1192
RS999235	S51	XP5	10.500	14.875†	4.375	2.18	P1271
RS999236	S42	LS26	14.625	23.875	9.250	2.18	P1192
RS999237	S51	LS39	12.000	18.000†	6.000	2.38	P1271
RS999238	S42	LS26	17.250	28.625†	11.375	2.38	P1192
RS999239	S42	XP4	14.500	23.125†	8.625	2.18	P1192
RS999240	XP12	LS24	12.750	19.125†	6.375	2.18	NONE
RS999241	XP12	LS24	13.625	20.875†	7.250	2.18	NONE
RS999244	LS77	LS39	14.125	21.750†	7.625	2.18	NONE
RS999248	LS28	LS28	15.125	24.000†	8.875	2.18	NONE
RS999254	L1	LS26	18.250	30.750	12.500	2.75	NONE
RS999255	S42	XP4	15.875	25.875†	10.000	2.18	P1270
RS999256	XP12	LS24	15.125	24.000†	8.875	2.18	NONE
RS999259	L1	LS25	13.875	21.500†	7.625	2.18	NONE
RS999260	LS29	LS25	13.875	21.500†	7.625	2.18	NONE
RS999261	L1	LS26	19.250	32.875	13.625	2.75	NONE
RS999262	LS47	LS47	15.125	23.875†	8.750	2.75	NONE
RS999263	S42	XP5	10.125	14.375†	4.250	2.18	P1192
RS999264	L1	LS26	15.625	24.375†	8.750	2.75	NONE
RS999265	S42	SPEC	11.000	15.250†	4.250	2.38	P1192
RS999266	XP7	LS26	16.875	28.125	11.250	2.38	NONE
RS999267	L1	LS26	14.500	22.250†	7.750	2.75	NONE
RS999268	S42	SPEC	13.875	20.750†	6.875	2.38	P1192
RS999269	LS47	LS47	16.875	27.250†	10.375	2.75	NONE
RS999272	S51	L1	10.375	14.875†	4.500	2.18	P1271
RS999273	L1	LS26	16.875	28.125	11.250	2.75	NONE
RS999274	LS47	LS47	16.375	26.250†	9.875	2.75	NONE
RS999275	XP7	LS26	19.375	32.875	13.500	2.18	NONE
RS999276	S51	LS47	11.750	17.500†	5.750	2.18	P1271
RS999278	XP7	LS26	15.500	25.125	9.625	2.18	NONE
RS999279	S51	XP12	11.000	13.375†	2.375	2.18	P1356
RS999280	S51	LS47	13.750	20.750†	7.000	2.38	P1271
RS999281	S51	XP12	9.875	14.125†	4.250	2.18	P1271
RS999282	S51	LS47	11.625	16.500†	4.875	2.38	P1271
RS999283	S51	LS47	13.375	20.000†	6.625	2.38	P1271
RS999284	LS30	LS28	14.125	22.000†	7.875	2.18	NONE

† Bumper Stop Unit. Dimension shown at Bumper Contact.

Specifications

All listed specifications are for convenience only and are subject to change without notice. Specifications are not intended for design of custom applications.

NOTE: Internal extension bumper may reduce perceived extended length by 1/2".
Extended and collapsed length dimensions shown for RS5000 shocks, others may vary slightly.

PART NO.	MOUNTING CODES		LENGTHS		RESERVE		PARTS PACK
	UPPER	LOWER	COMP.	EXT.	TRAV.	TUBE	
RANCHO RS9000XL SHOCK ABSORBERS — Continued							
RS999285	LS38	LS38	15.625	25.000†	9.375	2.38	NONE
RS999286	LS39	LS39	17.250	28.250†	11.000	2.38	NONE
RS999287	LS39	LS39	18.500	30.500†	12.000	2.38	NONE
RS999288	S51	LS42	12.750†	15.250†	2.500	2.18	P1271
RS999289	S51	LS42	15.875†	21.625†	5.750	2.18	P1271
RS999295	S51	LS42	10.625	15.250†	4.625	2.38	P1271
RS999296	S51	LS42	13.750	21.625†	7.875	2.38	P1271
RS999297	LS47	LS47	18.500	30.500†	12.000	2.75	NONE
RS999299	XP7	LS47	13.750	21.000†	7.250	2.18	NONE
RS999300	S4	LS22	10.125	14.500†	4.375	2.18	P1132
RS999301	XP7	LS47	14.625	23.000†	8.375	2.18	NONE
RS999303	LS47	LS47	15.375	24.125†	8.750	2.38	NONE
RS999304	LS47	LS44	16.875	27.250†	10.375	2.38	NONE
RS999305	S51	LS68	14.125	22.000†	7.875	2.18	P1356
RS999306	LS54	LS54	12.375	17.750†	5.375	2.18	NONE
RS999307	S51	S51	13.500	14.750†	2.375	2.18	NONE
RS999308	XP5	LS39	15.250	23.500†	8.250	2.18	NONE
RS999309	S5	SPEC	17.375	19.500†	2.125	2.18	P1356
RS999310	XP5	LS47	17.750	27.625†	9.875	2.18	NONE
RS999311	L1	LS39	13.625	21.000†	7.500	2.18	NONE
RS999312	LS44	LS44	10.500	14.625†	4.250	2.18	NONE
RS999313	L1	LS39	12.500	19.000†	6.625	2.18	NONE
RS999314	L1	LS39	13.000	20.000†	7.000	2.18	NONE
RS999317	S51	LS39	18.000	29.000†	11.000	2.38	P1356
RS999319	S42	LS29	14.000	22.500†	8.375	2.18	P1192
RS999320	S42	LS29	13.000	20.250†	7.375	2.18	P1193
RS999326	S5	LS38	14.000	21.750†	7.750	2.18	P1356
RS999327	XP6	LS38	13.875	21.125†	7.245	2.18	NONE
RS999328	XP6	LS38	14.500	22.625†	8.125	2.18	NONE
RS999329	S5	LS38	15.375	25.000†	9.625	2.18	P1356
RS999330	XP6	LS38	16.000	25.750†	9.750	2.18	NONE
RS999758	S51	LS51	17.750	24.125	5.750	2.000	P1356
RS999762	S51	LS43	13.625	18.250†	4.625	SPEC	P1356
RS999763	S51	LS44	13.500	18.125†	4.625	SPEC	P1167
RS999764	S15	SPEC	7.625	12.125†	4.500	SPEC	P1372
RS999766	S51	LS43	13.625	18.000†	4.375	SPEC	P1356
RS999767	S15	SPEC	16.625	21.625†	5.000	SPEC	P1388
RS999769	S15	SPEC	21.375	26.375†	5.000	SPEC	P1388
RS999771	S51	LS92	11.000	14.750†	3.750	SPEC	P1356
RS999773	S51	LS92	15.125	19.000†	3.875	SPEC	P1356
RS999774	S15	LS95	17.375	21.625†	4.250	SPEC	P1388
RS999777	S5	LS43	16.875	21.875†	5.000	SPEC	NONE
RS999780	S51	LS93	16.500	20.000	2.875	2.000	P1356
RS999781	S51	LS94	15.625	20.250	5.750	2.000	P1356
RS999784	S1	SPEC	19.000	22.875†	3.875	SPEC	P1426
RS999785	S1	SPEC	13.875	17.750†	3.875	SPEC	P1426, P1415
RS999786	S1	SPEC	19.000	23.000†	3.750	SPEC	P1426
RS999787	S5	LS35	11.000	15.000†	4.000	SPEC	P1356
RS999788	S2	SPEC	15.750	21.375†	5.625	SPEC	P1466
RS999789	S2	SPEC	18.625	24.500†	5.875	SPEC	P1466
RS999790	S5	LS39	11.000	15.000†	4.000	SPEC	P1356
RS999791	S2	LS38	11.000	15.875†	4.875	SPEC	P1358
RS999800	S2	SPEC	13.750	18.375	4.250	2.000	P1504, P1415, P1510

† Bumper Stop Unit. Dimension shown at Bumper Contact.

Rancho only engineers its shock absorbers for the applications listed in this catalog. Misapplication of Rancho shock absorbers will result in reduced handling and braking ability and voids warranty. Product Specifications Subject To Change Without Notice.

All listed specifications are for convenience only and are subject to change without notice. Specifications are not intended for design of custom applications.

Specifications

ADD-A-LEAF SPECIFICATIONS

ADD-A-LEAF KIT NUMBER	LENGTH END TO END	WIDTH	LEAF THICKNESS	ARCH	SINGLE LEAF	LEAF STYLE
RS50012	44.000"	2.500"	0.360"	4.500"	502	Flat
RS50112	50.500"	3.000"	0.360"	5.000"	503	Flat
RS50212	44.000"	2.500"	0.360"	4.500"	502	Flat
RS60012	27.500"	2.300"	0.630"	1.900"	504	Tapered
RS60013	45.625"	2.500"	0.320"	8.650"	319	Flat
RS60112	22.000"	2.000"	0.400"	2.080"	505	Tapered
RS60312	25.750"	3.000"	0.630"	1.500"	507	Tapered
RS60412	50.000"	3.000"	0.400"	6.375"	508	Flat
RS60512	32.500"	2.000"	0.400"	3.625"	509	Flat
RS60612	22.000"	2.360"	0.400"	2.000"	510	Tapered
RS60613	44.750"	2.500"	0.260"	6.750"	313	Flat
RS60614	50.000"	2.500"	0.260"	4.750"	327	Flat
RS60622	45.750"	2.360"	0.260"	7.000"	518	Flat
RS60622	36.000"	2.360"	0.260"	4.750"	519	Flat
RS60624	46.000"	3.000"	0.320"	7.500"	314	Flat
RS60624	49.750"	3.000"	0.320"	8.000"	506	Flat
RS60632	42.750"	2.500"	0.260"	6.250"	316	Flat
RS60633	33.500"	2.500"	0.390"	3.625"	321	Flat
RS60633	42.750"	2.500"	0.260"	5.000"	320	Flat
RS60634	55.000"	2.500"	0.390"	7.850"	317	Flat
RS60635	42.750"	2.360"	0.260"	6.250"	324	Flat
RS60636	24.250"	2.375"	0.250"	2.375"	325	Flat
RS60637	36.000"	2.500"	0.262"	4.750"	328	Flat
RS60639	43.000"	3.000"	0.354"	7.610"	329	Flat
RS60642	50.500"	3.000"	0.390"	7.500"	330	Flat
RS60645	42.000"	2.500"	0.323"	7.900"	331	Tapered
RS60665	22.000"	2.360"	0.400"	2.000"	510	Tapered
RS60688	32.000"	2.500"	0.323"	4.250"	335	Flat
RS60675	33.625"	2.500"	0.390"	3.440"	333	Flat
RS60712	22.375"	1.750"	0.440"	2.250"	511	Tapered
RS60812	46.750"	2.500"	0.310"	7.260"	512	Flat
RS60913	48.750"	2.500"	0.260"	5.500"	513	Flat
RS70062	48.000"	2.500"	0.320"	8.650"	318	Flat
RS60653	21.500"	3.000"	0.710"	1.130"	332	Tapered

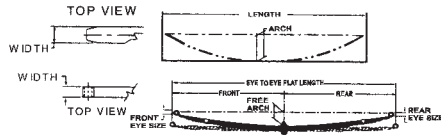

COIL SPRING SPECIFICATIONS

COIL SPRINGS	RATE LBS. PER IN.	FREE LENGTH	WIRE SIZE	COIL KIT(S) NUMBER
RS311	180	16.830"	0.560"	6424, 6449
RS312	222	14.850"	0.578"	6425, 6448
RS601	545	18.680"	0.781"	80114
RS602	485	17.450"	0.750"	6402, 6403
RS607	545	19.680"	0.781"	6400, 6404, 6405
RS608	240	18.000"	0.625"	6423
RS609	460	19.180"	0.775"	6406, 6422
RS610	250	22.060"	0.750"	6481
RS611	459	15.320"	0.718"	6408
RS614	1050	14.250"	0.843"	6500
RS615	130	19.230"	0.531"	6503, 6506
RS616	150	14.760"	0.593"	6502, 6503, 6506
RS618	130	18.730"	0.531"	6502
RS620	460	18.180"	0.775"	6420, 6430, 6436
RS621	804	12.420"	0.718"	6455, 6460
RS622	1190	13.500"	0.905"	6458
RS623	680	12.830"	0.625"	6457
RS630	435	15.690"	0.688"	6421, 6431, 6432, 6433
RS631	520	16.520"	0.718"	6434, 6435
RS632	460	15.800"	0.718"	6439, 6441
RS633	1190	14.200"	0.905"	6462
RS634	1038	12.890"	0.843"	6465
RS635	1038	10.390"	0.812"	6463
RS636	240	18.440"	0.625"	6413
RS637	200	14.980"	0.562"	6414
RS650	227	13.350"	0.578"	6490
RS663	1000	19.760"	0.906"	6243
RS665	825	17.850"	0.843"	6289
RS669	925	17.280"	0.843"	6275
RS670	865	16.490"	0.812"	6275
RS672	300	16.910"	0.750"	6546

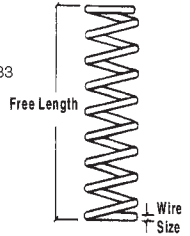

SPRING SPECIFICATIONS

LEAF SPRING NUMBER	RATE LBS. PER IN.	EYE TO EYE FLAT LENGTH	ARCH (FREE)	EYE SIZE FRONT	EYE SIZE REAR	WIDTH	THICKNESS IN CENTER	OFF-SET (CNTR. BOLT) FRONT/REAR	NUMBER OF LEAVES
RS305	300	45.120"	4.050"	1.190"	1.190"	2.360"	0.980"	—	3
RS305L	300	45.120"	4.700"	1.190"	1.190"	2.360"	0.980"	—	3
RS306	160	47.820"	7.700"	1.500"	1.500"	2.360"	1.490"	20.470"/27.350"	5
RS610	250	22.060"	—	—	—	—	0.750"	—	—
RS820	509	43.860"	6.970"	1.170"	1.170"	2.000"	1.940"	—	6
RS825	448	56.920"	7.110"	1.170"	1.170"	2.000"	2.410"	—	6
RS16243	711	36.700"	3.680"	0.750"	0.880"	1.750"	1.440"	—	4
RS24043	604	44.640"	5.750"	1.250"	1.500"	2.500"	1.440"	—	4
RS27743	492	50.390"	6.750"	1.000"	1.500"	1.750"	1.700"	24.250"/26.140"	4
RS40054S	672	46.900"	3.500"	1.130"	1.500"	2.500"	1.920"	—	5
RS41054S	720	43.570"	2.860"	1.130"	1.500"	2.500"	2.010"	—	5
RS42054S	605	48.040"	3.190"	1.020"	1.020"	2.500"	1.920"	—	5
RS42055	428	48.080"	1.750"	1.000"	1.000"	2.500"	1.700"	—	5
RS42056	428	48.040"	2.850"	1.030"	1.030"	2.500"	1.700"	—	5
RS43033	391	44.130"	5.450"	1.380"	1.380"	2.750"	1.660"	20.310"/23.820"	6
RS43133	290	45.470"	8.360"	1.380"	1.380"	2.750"	1.500"	20.650"/24.820"	6
RS44010	353	36.240"	3.170"	0.560"	0.870"	1.750"	1.380"	—	5
RS44020	349	36.500"	4.370"	0.560"	0.870"	1.500"	1.380"	—	5
RS44044	300	47.000"	6.580"	1.500"	1.500"	2.500"	1.660"	22.500"/24.500"	6
RS44046	256	36.800"	2.750"	1.500"	1.500"	2.000"	1.050"	—	4
RS44047	174	45.200"	6.750"	1.250"	1.500"	2.000"	0.790"	—	3
RS44050	174	46.000"	7.620"	1.250"	1.500"	2.000"	0.790"	—	4
RS44051	644	52.500"	6.000"	2.000"	2.000"	3.000"	2.000"	24.000"/28.500"	5
RS44053	834	52.500"	6.250"	2.000"	2.000"	3.000"	2.240"	24.000"/28.500"	5
RS44054	435	55.700"	6.500"	2.050"	1.720"	3.000"	2.750"	27.600"/28.100"	9
RS44055	435	55.700"	4.950"	2.050"	1.720"	3.000"	2.750"	27.600"/28.100"	9
RS44056	460	55.700"	7.600"	2.050"	1.720"	3.000"	2.820"	27.600"/28.100"	9
RS44057	450	55.700"	6.100"	2.050"	1.720"	3.000"	2.750"	27.600"/28.100"	9
RS44061	335	40.000"	3.590"	0.880"	0.880"	1.750"	1.660"	—	6
RS44062	314	40.500"	5.100"	0.880"	0.880"	1.500"	1.660"	—	6
RS44082	330	44.260"	5.670"	1.500"	1.000"	2.500"	1.930"	—	7
RS44091	300	44.880"	4.250"	1.500"	1.000"	2.000"	1.450"	—	5
RS44092	325	44.880"	5.500"	1.500"	1.000"	2.000"	1.450"	—	5
RS44110	330	42.000"	4.640"	0.560"	0.870"	1.750"	1.540"	—	5
RS44120	316	42.500"	5.630"	0.560"	0.870"	1.750"	1.540"	—	5
RS44121	196	64.000"	2.680"	1.500"	1.500"	2.500"	0.900"	—	2
RS44146	156	39.360"	4.050"	1.500"	1.500"	2.000"	1.180"	—	4
RS44147	200	45.600"	6.650"	1.250"	1.500"	2.500"	1.050"	—	4
RS44148	186	51.500"	5.870"	1.500"	1.500"	2.500"	1.390"	23.000"/28.500"	5
RS44150	200	45.900"	7.250"	1.250"	1.500"	2.500"	1.050"	—	4
RS44154	280	59.150"	8.200"	2.050"	1.720"	3.000"	2.330"	25.500"/33.650"	8
RS44161	280	46.100"	4.150"	0.880"	0.880"	1.750"	1.840"	—	6
RS44162	287	46.700"	6.150"	0.880"	0.880"	1.750"	1.840"	—	6
RS44182	308	45.680"	5.670"	1.500"	1.000"	2.500"	1.660"	—	6
RS44191	290	45.400"	4.350"	1.500"	1.000"	2.500"	1.380"	—	5
RS44192	290	45.400"	5.600"	1.500"	1.000"	2.500"	1.380"	—	5
RS46053S	590	54.090"	4.920"	1.610"	1.380"	3.000"	1.450"	26.810"/27.280"	3
RS86201	340	46.900"	3.750"	1.500"	1.130"	2.500"	1.040"	—	3
RS86202	450	46.900"	3.000"	1.500"	1.130"	2.500"	1.690"	—	5
RS86206	520	46.900"	3.720"	1.500"	1.130"	2.500"	1.800"	—	5
RS86209	287	52.000"	7.750"	1.500"	1.500"	2.500"	2.290"	—	6
RS86210	348	46.900"	3.470"	1.130"	1.500"	2.500"	2.430"	—	9
RS86211	230	52.000"	9.170"	1.500"	1.500"	2.500"	1.750"	—	6

Rancho only engineers its shock absorbers for the applications listed in this catalog. Misapplication of Rancho shock absorbers will result in reduced handling and braking ability.

Specifications

All listed specifications are for convenience only and are subject to change without notice. Specifications are not intended for design of custom applications.

STEEL SLEEVE SPECIFICATIONS

PART NUMBER	OD	ID	LENGTH
RS420	0.750"	0.560"	3.650"
RS421	0.630"	0.440"	3.700"
RS422	0.750"	0.550"	3.510"
RS423	0.630"	0.440"	3.510"
RS424	0.750"	0.560"	3.000"
RS425	0.560"	0.440"	1.800"
RS426	0.630"	0.440"	2.200"
RS427	0.630"	0.500"	2.800"
RS428	0.750"	0.560"	2.750"
RS429	0.750"	0.560"	2.950"
RS430	0.750"	0.630"	3.370"
RS431	0.750"	0.560"	3.400"
RS440	0.810"	0.500"	1.250"
RS441	0.810"	0.500"	0.310"
RS445	0.560"	0.500"	1.250"
RS448	0.750"	0.500"	1.400"
RS452	1.000"	0.750"	1.750"
RS453	0.810"	0.500"	1.750"
RS457	0.750"	0.560"	2.600"
RS460	0.880"	0.630"	0.630"
RS461	0.750"	0.630"	1.900"
RS464	0.630"	0.440"	5.020"
RS468	0.750"	0.500"	2.550"
RS471	0.750"	0.500"	3.050"
RS473	0.750"	0.500"	2.450"
RS474	0.690"	0.500"	2.750"
RS479	0.750"	0.560"	1.800"
RS483	0.750"	0.560"	2.040"
RS485	0.750"	0.500"	1.600"
RS411001	0.630"	0.560"	1.600"
RS411002	0.750"	0.500"	1.630"
RS411012	0.630"	0.500"	1.310"
RS603538	0.630"	0.440"	2.610"
RS603540	0.630"	0.500"	1.610"
RS603545	0.630"	0.380"	0.500"

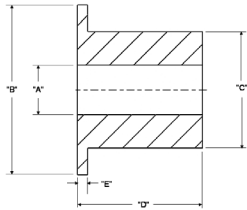

U-BOLT SPECIFICATIONS

PART NUMBER	THREAD SIZE	ROUND OR SQUARE	ID WIDTH	ID LENGTH
RS17402	5/8"	Round	3.630"	13.000"
RS17404	1/2"	Round	3.250"	7.630"
RS17406	1/2"	Round	3.500"	8.000"
RS17407	9/16"	Square	2.430"	6.630"
RS17408	9/16"	Round	2.560"	6.380"
RS17410	1/2"	Round	2.310"	6.500"
RS17413	1/2"	Round	2.550"	6.500"
RS17414	1/2"	Round	3.200"	6.750"
RS17415	1/2"	Round	2.880"	6.750"
RS17431	5/8"	Round	3.000"	9.250"
RS17433	5/8"	Round	2.810"	9.250"
RS17436	5/8"	Round	3.250"	8.750"
RS17454	1/2"	Round	2.550"	6.250"
RS17455	1/2"	Round	3.130"	6.550"
RS17463	1/2"	Round	2.850"	10.000"
RS17469	9/16"	Round	3.250"	6.800"
RS17470	9/16"	Round	3.250"	7.750"
RS17474	5/8"	Round	3.650"	9.000"
RS17475	5/8"	Round	3.650"	10.120"
RS17477	5/8"	Round	2.960"	7.800"
RS17479	9/16"	Square	2.560"	16.000"
RS17482	9/16"	Round	3.220"	13.120"
RS17483	9/16"	Round	3.250"	10.750"
RS17484	5/8"	Round	2.980"	12.120"
RS17485	5/8"	Round	3.300"	12.620"
RS17486	9/16"	Square	2.560"	14.500"
RS17487	5/8"	Square	2.560"	9.000"
RS17488	9/16"	Square	2.560"	8.500"
RS17489	9/16"	Square	2.560"	13.000"
RS17494	9/16"	Round	3.000"	7.500"
RS17495	9/16"	Square	2.560"	11.000"
RS17497	5/8"	Round	2.980"	10.620"
RS17498	9/16"	Round	3.750"	8.000"
RS17499	9/16"	Stud	-----	4.590"
RS740012	5/8"	Round	3.270"	13.000"
RS740013	9/16"	Round	3.240"	12.100"
RS740014	9/16"	Square	2.560"	12.500"
RS740015	9/16"	Square	3.110"	10.000"
RS740016	5/8"	Square	2.550"	10.150"
RS740018	5/8"	Round	3.010"	10.600"
RS740035	9/16"	Square	2.430"	7.750"

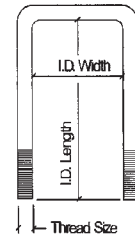
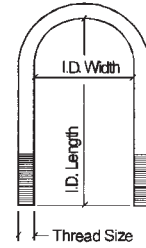

CAUTION: THIS U-BOLT LISTING IS INTENDED FOR DIRECT REPLACEMENT OF EXISTING CATALOG APPLICATIONS ONLY; not intended for custom applications.

Notes: For individual U-bolts, delete the 1 at the front of the part numbers.

BUSHING SPECIFICATIONS

PART NUMBER	BEVELED LIP	DIMENSION				
		A	B	C	D	E
RS520	No	0.740"	1.900"	1.510"	1.750"	0.560"
RS521	Yes	0.616"	1.900"	1.135"	1.735"	0.560"
RS523	Yes	0.616"	1.900"	1.135"	1.665"	0.490"
RS524	No	0.740"	1.900"	1.510"	1.450"	0.500"
RS526	—	0.615"	—	1.190"	2.000"	—
RS527	No	0.620"	1.420"	1.025"	1.310"	0.160"
RS529	—	0.738"	—	1.256"	1.250"	—
RS532	Yes	0.510"	1.400"	1.010"	1.285"	0.270"
RS533	Yes	0.510"	1.400"	1.010"	1.535"	0.270"
RS534	Yes	0.616"	1.900"	1.135"	1.500"	0.325"
RS536	No	0.710"	1.450"	1.190"	1.320"	0.130"
RS537	—	0.750"	1.480"	1.250"	1.610"	—
RS538	No	0.590"	1.250"	0.950"	1.460"	0.110"
RS540	—	0.875"	—	1.500"	1.250"	—
RS541	No	0.585"	2.000"	1.375"	1.460"	0.110"
RS553	Yes	0.750"	1.900"	1.500"	1.250"	0.200"
RS554	Yes	0.750"	1.900"	1.510"	0.975"	0.250"
RS624	No	0.750"	1.900"	1.510"	1.425"	0.250"
RS625	No	0.750"	1.900"	1.510"	1.425"	0.250"
RS626	Yes	0.750"	1.900"	1.500"	1.300"	0.120"
RS627	Yes	0.750"	1.800"	1.260"	1.460"	0.300"
RS628	No	0.750"	1.900"	1.510"	1.430"	0.220"
RS629	No	0.713"	1.900"	1.510"	1.310"	0.170"

NOTES: Steel sleeve is advisable for most bushings.
 •Part Number 537 is a shock bushing.
 •Part Number 625 is high tensile strength material.

BUMP STOP SPECIFICATIONS

BUMP STOP	A	B	C	D
RS8202	4.500"	3.000"	3.000"	2.500"
RS8203	2.850"	3.500"	2.000"	1.750"
RS8204	2.850"	4.500"	2.000"	1.750"
RS8205	2.850"	5.500"	2.000"	1.750"
RS8206	2.850"	2.000"	2.000"	1.750"
RS8207	2.850"	3.500"	2.000"	1.750"
RS8208	2.850"	3.750"	2.000"	1.750"
RS8213	2.850"	5.000"	2.000"	1.750"
RS8216	2.850"	5.000"	2.000"	1.750"

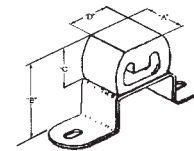

FRACTION TO DECIMALS					
1/8"	=	.125/.13	11/16"	=	.688/.69
1/4"	=	.250/.25	23/32"	=	.719/.72
3/8"	=	.375/.38	3/4"	=	.750/.75
7/16"	=	.438/.44	13/16"	=	.813/.81
1/2"	=	.500/.50	7/8"	=	.875/.88
9/16"	=	.563/.56	15/16"	=	.938/.94
5/8"	=	.625/.63	1"	=	1.000/1.00